

Lot 8

The Jenkins



2 Bed +
Study



2 Bath



Double
Garage



Image was produced prior to planning approval, statutory approval and commencement of construction and is subject to change. The information and image depicting interiors and exteriors are intended only as a guide and are not to be relied on as a representative of the final product.

Designed for easy living, The Jenkins is an inviting home. The open plan layout allows an easy flow between the lounge, dining, and kitchen, opening to an outdoor deck, perfect for entertaining. There are two bedrooms, the main with an ensuite, a spacious family bathroom and a study. A double garage completes this stylish home.

Floor Areas

Main Living Area 91.9m²

Garage Area 32.5m²



Alfresco Area 16.3m²

Porch Area 4.3m²

Total 145.4m²

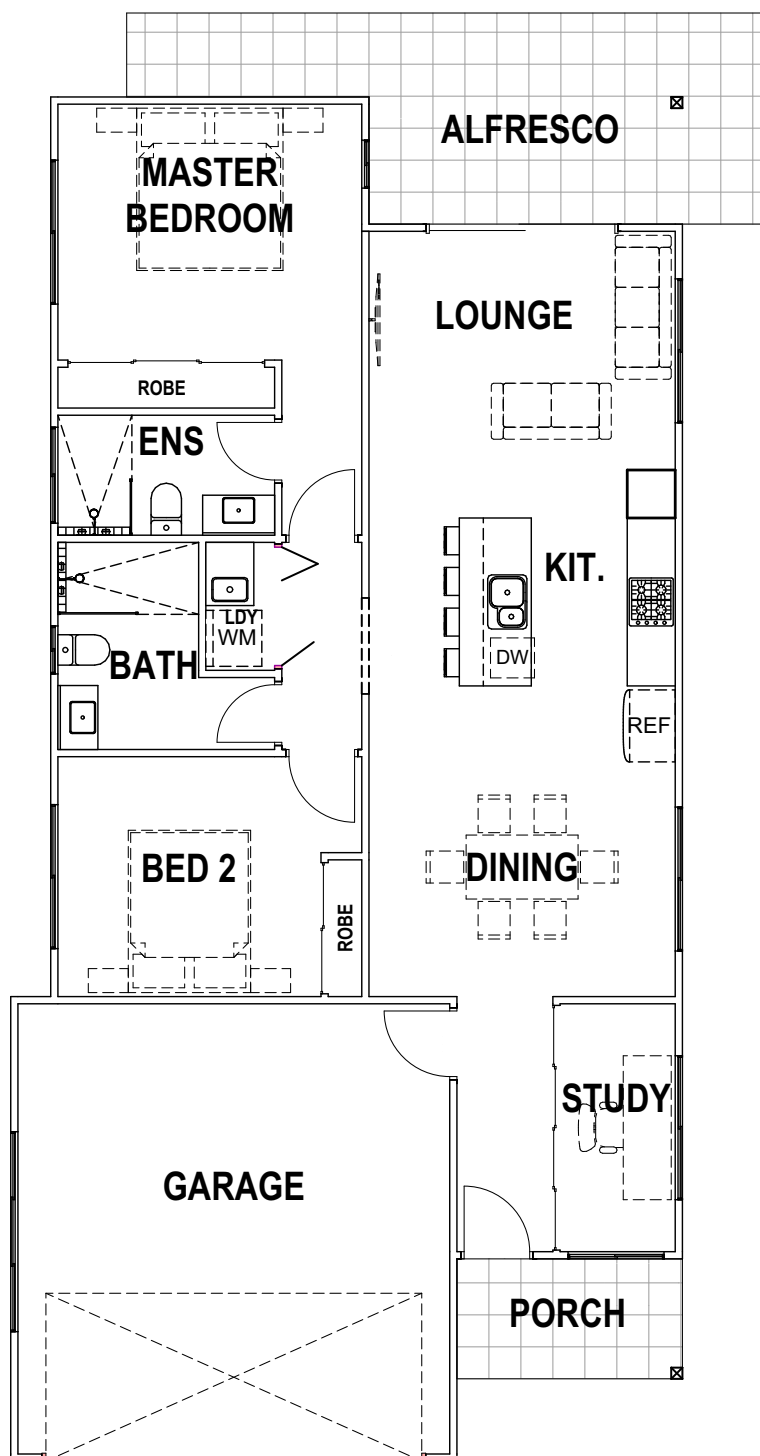

Image was produced prior to planning approval, statutory approval and commencement of construction and is subject to change. The information and image depicting interiors and exteriors are intended only as a guide and are not to be relied on as a representative of the final product.