

\$279,000*

 238sqm  2 Bed  1.5 Bath  1 Car



Lot 28

19-51 Warral Road, West Tamworth, NSW 2340

Design Features

- Large home total size 132.6m²
- Keep 100% of any capital gain
- Reverse cycle air conditioner, gas point. External gas point to alfresco
- Under bench oven and dishwasher
- Ceiling fans to bedroom and living
- Gas cooktop
- Easy-care timber look vinyl floors in living areas
- Carpets to bedrooms, tiled wet areas
- Fully insulated, energy efficient
- Built-in wardrobes
- Internal laundry with spacious built-ins
- On site caretaker
- No stamp duty or exit payments
- Government subsidy for land lease fees where eligible





- Internal living 89.3m²
- Carport / Alfresco 39.0m²
- Porch 4.3m²

Total 132.6m²

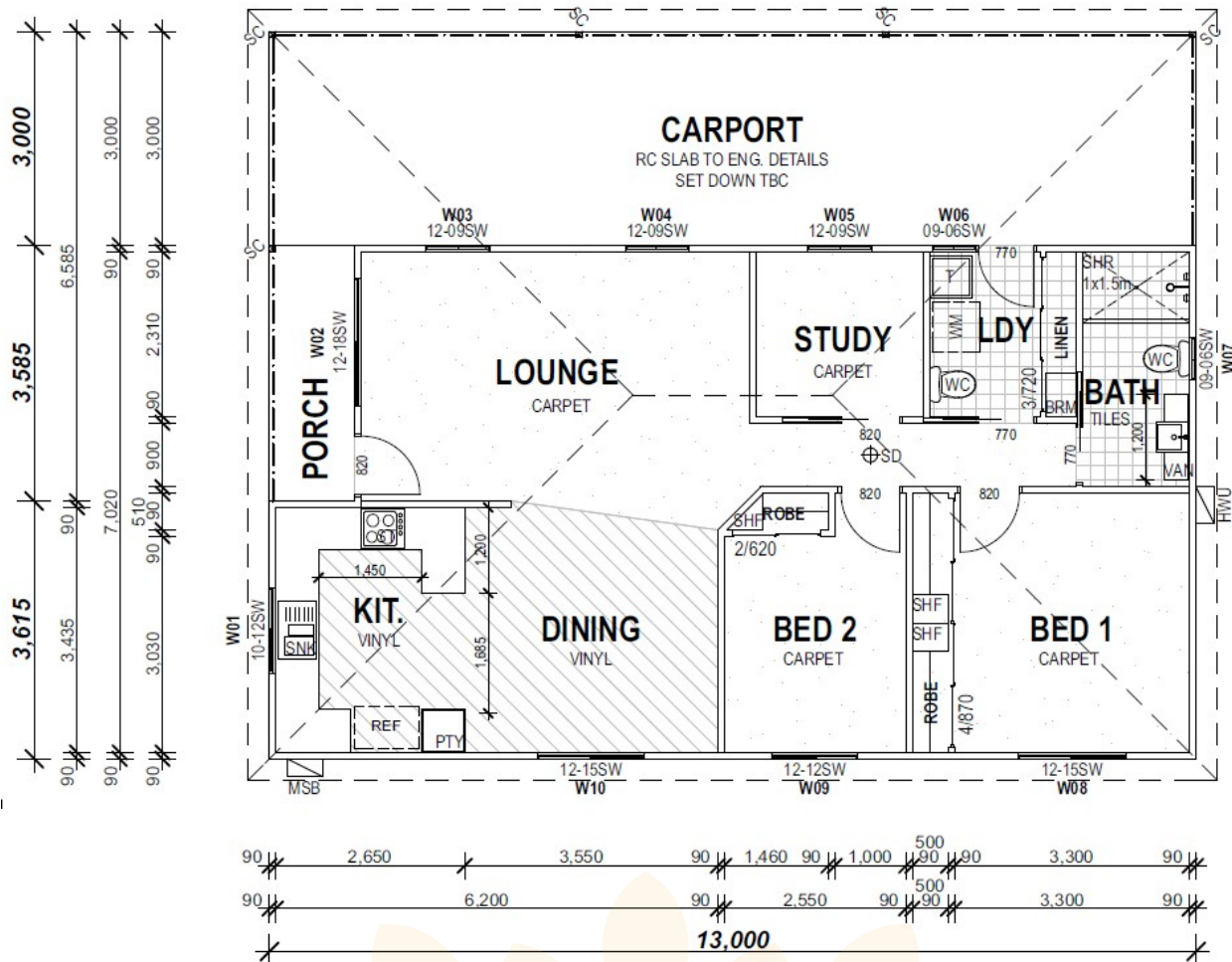
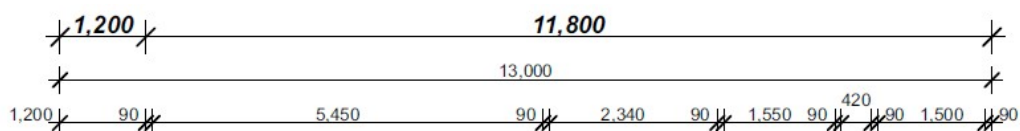

*Land Lease Fees apply. GST Inclusive. We reserve the right to vary or change prices and specifications without notice. Dimensions are approximate only. All drawings and photographs are for illustrative purposes only.